

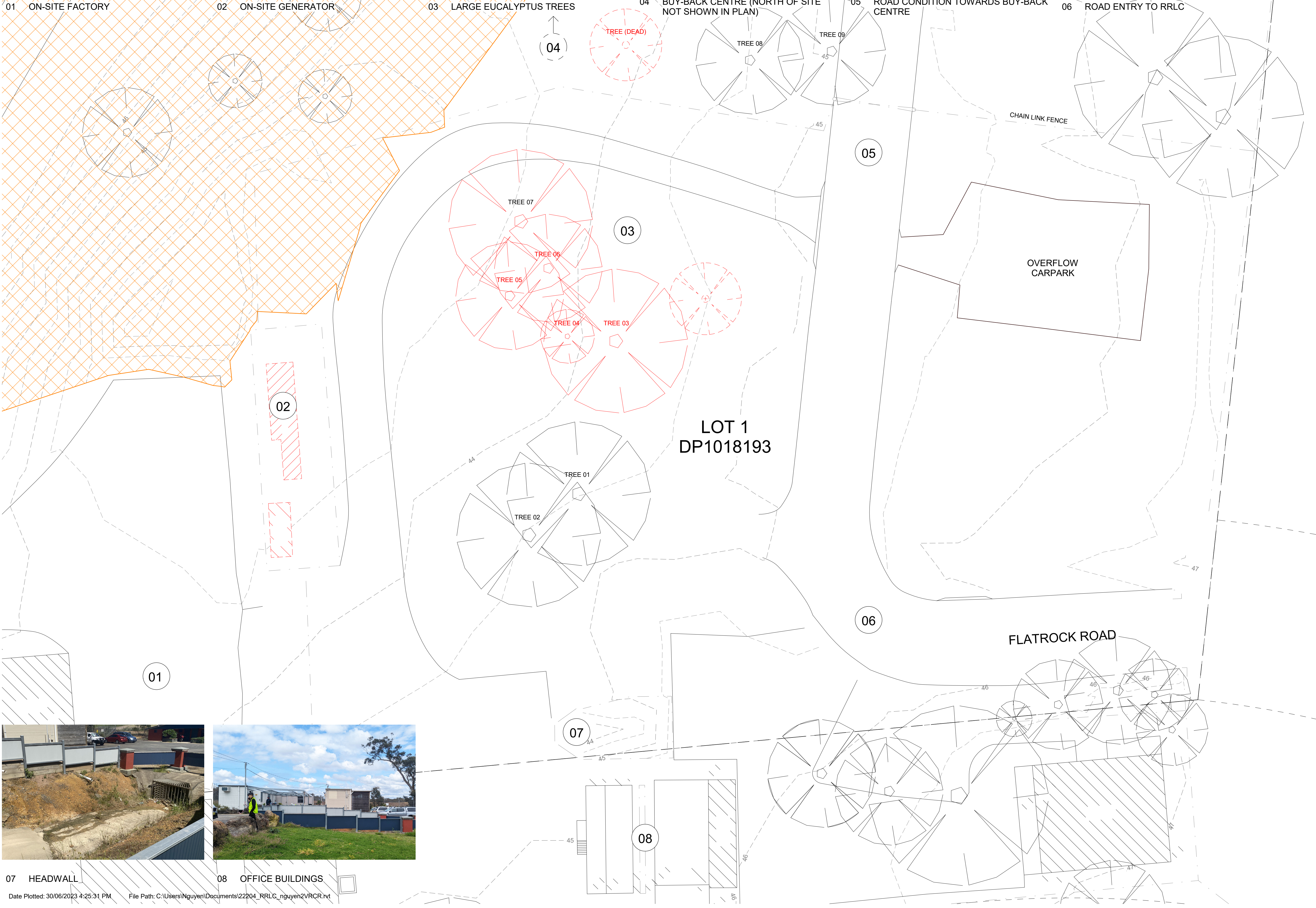

GENERAL NOTES
DO NOT SCALE FROM THIS DRAWING
CONFIRM ALL DIMENSIONS AND SETOUTS ON SITE PRIOR TO MANUFACTURE & INSTALLATION
ALL WORK IN ACCORDANCE WITH RELEVANT AUSTRALIAN STANDARDS
TO BE READ IN CONJUNCTION WITH ENGINEERS DOCUMENTS.
KEY PLAN



LEGEND

0 m 4 m 8 m 12 m 16 m

— SITE BOUNDARY

TREES (DEAD) TO BE REMOVED
REFER TO ARBORIST REPORT FOR FURTHER DETAIL

TREES TO BE REMOVED
REFER TO ARBORIST REPORT FOR FURTHER DETAIL

BUILDINGS TO BE RELOCATED

INFERRED EXTENT OF LANDFILL
REFER TO GEOTECHNICAL REPORT FOR FURTHER DETAIL



01	07/06/23	Development Application
Rev	Date	Description

Sydney Level 2, 79 Myrtle St
Chippendale 2008
Nominated Architect: Gerard Reinmuth 6629
T 02 9698 2198
F 02 9698 2353

Hobart 181 Elizabeth St
Hobart 7000
Nom. Architect TAS: Scott Balmforth CC1041T
Registered Architect VIC: Scott Balmforth 16263
T 03 6234 6372
F 03 6231 4939

TERROIR

Project:
Shoalhaven City Council
Resource Recovery Learning Centre
120 Flatrock Road, Mundamia NSW
Drawing Description:
EXISTING SITE PLAN

Drawn by: AN Checked by: JL Scale: 1:200 @ A1

PROJECT NO:	DWG NO:	REV NO:
22204	DA-00-02	01

Drawing Status: DEVELOPMENT APPLICATION